



CORPORATE FLEET
SERVICES

2008 Embraer Legacy 600

S/N 14501080

2008 Legacy 600

Serial Number 14501080 N865LS



AIRFRAME — EEC-ENHANCED

Airframe: TT: 2988.9 Hrs 2035 Landings (Enrolled EEC-Enhanced)

Rolls Royce AE 3007A1E – **Enrolled RRCC**

Engine #1: TT: 2977.4 Hrs 2029 Cycles

Engine #2: TT: 2988.9 Hrs 2035 Cycles

Hamilton Sundstrand T-62T-40C14 – **Enrolled EEC-Enhanced**

APU: TT: 3279.3 Hrs

MAINTENANCE

Enrolled in Embraer Executive Care – Enhanced, Enrolled in CAMP

MAKE OFFER

THESE SPECIFICATIONS ARE PRESENTED AS INTRODUCTORY INFORMATION ONLY. THEY DO NOT CONSTITUTE REPRESENTATIONS OR WARRANTIES OF ANY KIND. ACCORDINGLY, YOU SHOULD RELY ON YOUR OWN INSPECTION OF THIS AIRCRAFT. THE AIRCRAFT IS SUBJECT TO PRIOR SALE, AND/OR REMOVAL FROM THE MARKET.

2008 Legacy 600

Serial Number 14501080 N865LS

AVIONICS

- (5) Honeywell Primus 1000 Flat Panel Display Units
- Honeywell Lightning Sensor System
- Electronic Flight Bag (EFB)
- ACARS
- Cockpit Printer
- Communications Management Unit (CMU) with 3rd VHF
- Dual Integrated Computers
- Dual Communication System (Integrated VHF/Mode S Diversity Transponder) w/ 8.33 Khz Frequency Spacing
- Dual Navigation Systems (NAV/ADF/DME)
- Dual FMS+GPS
- Dual Stall Protection System
- SELCAL
- CAT I and CAT II
- Aux Flight Data Acquisition and Management Unit (AFDAMU)
- Dual Inertial Reference System (IRS)
- Dual Radio Management Units (RMU)
- Emergency Locator Transmitter (ELT)
- Dual Analog Clocks
- Solid State Cockpit Voice Recorder (CVR)
- Solid State Flight Data Recorder (FDR)
- Aural Warning Unit
- Dual Air Data Computers (ADC)
- Meets RVSM Requirements
- EGPWS/Wind Shear Detector and Escape Guidance
- Integrated Stand-by Instruments System (ISIS)
- Weather Radar w/Dual Control Panel and Turbulence Detection
- TCAS 2000 w/Change 7
- HF Radio w/2nd HF

ADDITIONAL EQUIPMENT

- Aircell Go-Go Internet System; Talk and Text
- Swift Broadband HSD
- Iridium ST-3100 and Aerocom In Flight Phone System
- (2) DVD Players
- Airshow 4000
- 115V/60Hz Utility Outlets
- Stereo Speaker System

2008 Legacy 600

Serial Number 14501080 N865LS



INTERIOR

13 Passenger Configuration, Galley, Forward Galley Including High-Temp Oven, One Refrigerator and One Nespresso Machine and Marble Floor, Forward Cabin, Four Single Club Chairs, Mid Cabin, Four-place Conference Group with Opposing Credenza. Aft Cabin, Two Single Club Chairs with Four Place Divan on Left Side. Lavatory, Aft Vacuum Lavatory with Marble Floor and Fwd Crew Lav. Cockpit Jump seat.



EXTERIOR

White, Star Blue Akzo Nobel, and Laser Blue with Teflon Coating.









2008 Legacy 600

Serial Number 14501080 N865LS

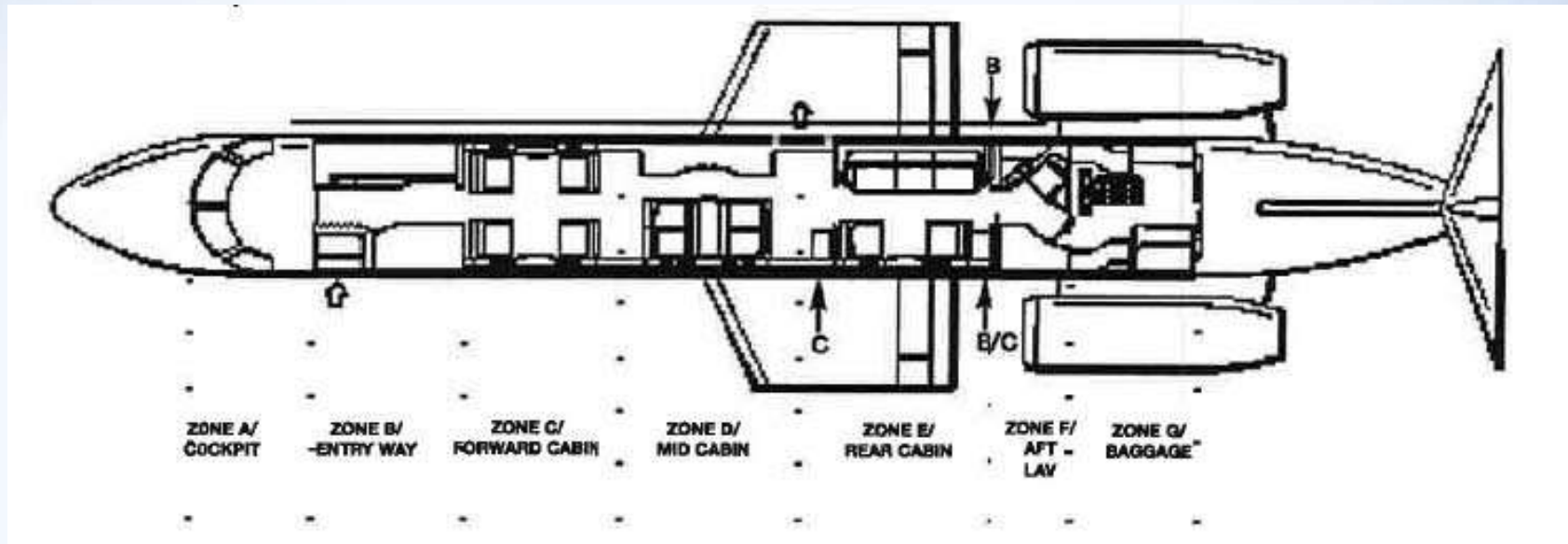



17039 KENTON DRIVE / THIRD FLOOR / CORNELIUS NC 28031 TEL: (704) 359-0007
FAX: (704) 359-0406 INFO@CFSJETS.COM